



Valentine's Meet 2026

Meet information

Dear swimmers, parents, coaches and team managers,

We look forward to welcoming you to Valentine's Meet 2026 on Saturday 7th and Sunday 8th February 2026.

Venue

Address: The Centre (Slough), Farnham Rd, Slough SL1 4UT

Schedule of events

Saturday 7th February 2026			
Session 1 - Warm up 11:45, Start 12:45			
101	Mixed	400	Free
102	Female	100	Breast
103	Male/Open	50	Back
Mid-session interval (15 mins)			
104	Female	200	Back
105	Male/Open	200	Breast
106	Female	50	Fly
107	Male/Open	100	Free
Session 2 - Warm up 16:55, Start 17:55			
201	Male/Open	200	IM
202	Female	200	Breast
203	Male/Open	50	Breast
204	Female	100	Fly
205	Male/Open	200	Back
206	Female	200	IM
207	Male/Open	100	Fly
208	Female	50	Free
Estimated end time 21:00			

Sunday 8th February 2026			
Session 3 - Warm up 12:30, Start 13:30			
301	Mixed	400	IM
302	Female	50	Back
303	Male/Open	100	Breast
304	Female	200	Fly
305	Male/Open	50	Fly
306	Female	100	Back
307	Male/Open	200	Free
Mid-session interval (30 mins)			
308	Female	200	Free
309	Male/Open	100	Back
310	Female	50	Breast
311	Male/Open	200	Fly
312	Female	100	Free
313	Male/Open	50	Free
Estimated end time 18:50			

Sign-in/warm-up times

Saturday 7th February 2026			
	Sign-in opens	Warm-up starts	Racing starts
Session 1	11:00	11:45	12:45
Session 2	16:10	16:55	17:55

Sunday 8th February 2026			
	Sign-in opens	Warm-up starts	Racing starts
Session 3	11:45	12:30	13:30

The pool will be open in the mid-session interval during Session 3.

There will be no access to the pool and changing village before 11:30 on Saturday 7th February and 12:15 on Sunday 8th February. The spectator gallery will be open from 11:30 on Saturday 7th February and 12:15 on Sunday 8th February.

Getting to the centre

The Centre (Slough) is located on Farnham Road, just north of Bath Road (the A4) near Slough town centre. Nearest motorway access is from M4 J6. Use postcode SL1 4UT for Sat Nav directions. The nearest train station is Slough served by National Rail mainline and the Elizabeth Line.

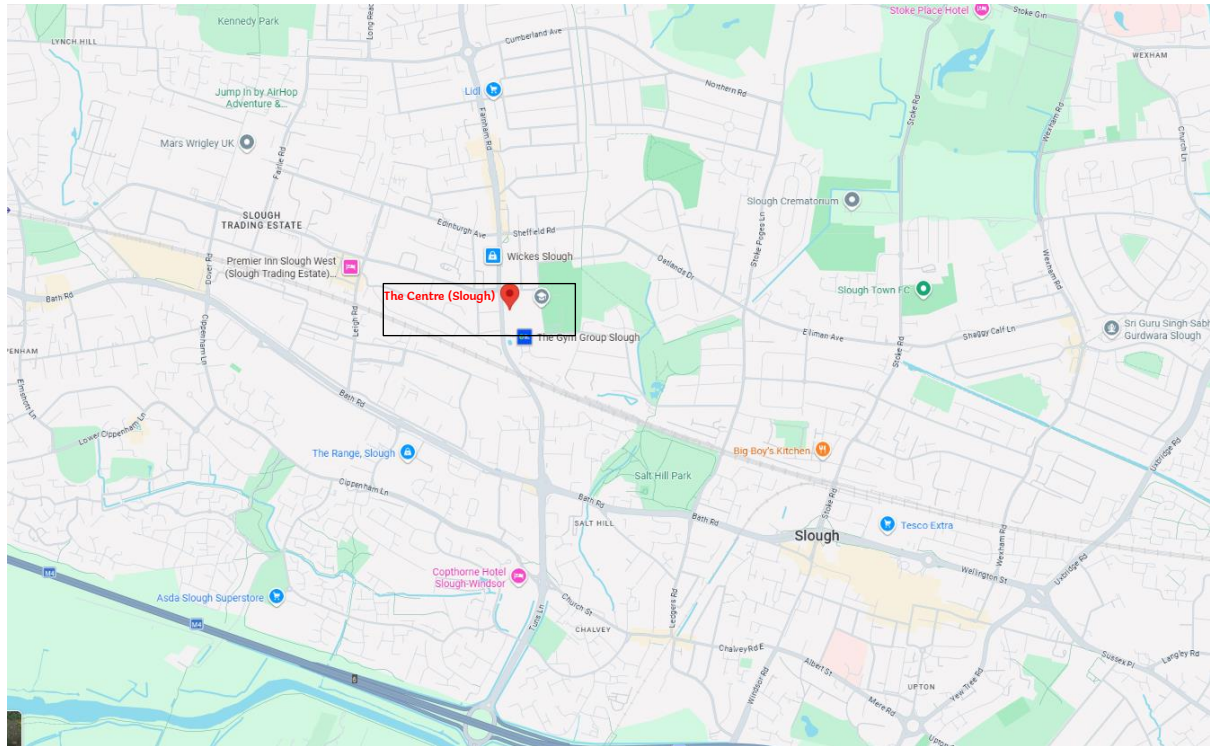

Car parking

Parking is available at the leisure centre (SL1 4UT) in the car parks edged in green below. Do not park in the spaces edged in red which are reserved for officials and for disabled users.



Parking at the centre is **limited to 3 hours with no return within 2 hours**. Note that sessions run longer than this so competitors and spectators are encouraged to park in the multi-storey car park (SL1 4RA). Parking may be pre-booked via JustPark: see <https://www.justpark.com/partner/parkopedia/checkout/807506> for further details.

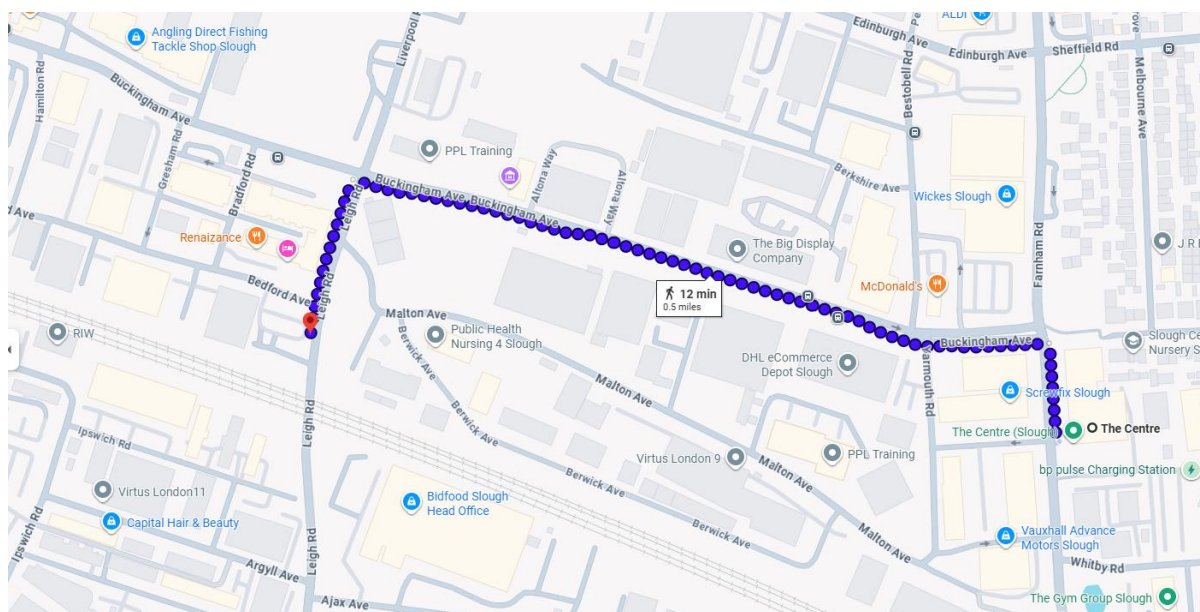

Sign-in

This is a sign-in meet.

All swimmers must sign in for each session. The sign-in desk will be in the main foyer of the leisure centre. Sign-in will close at the start of warm-up for the session. **Swimmers who do not sign in will be scratched.**

Pool layout

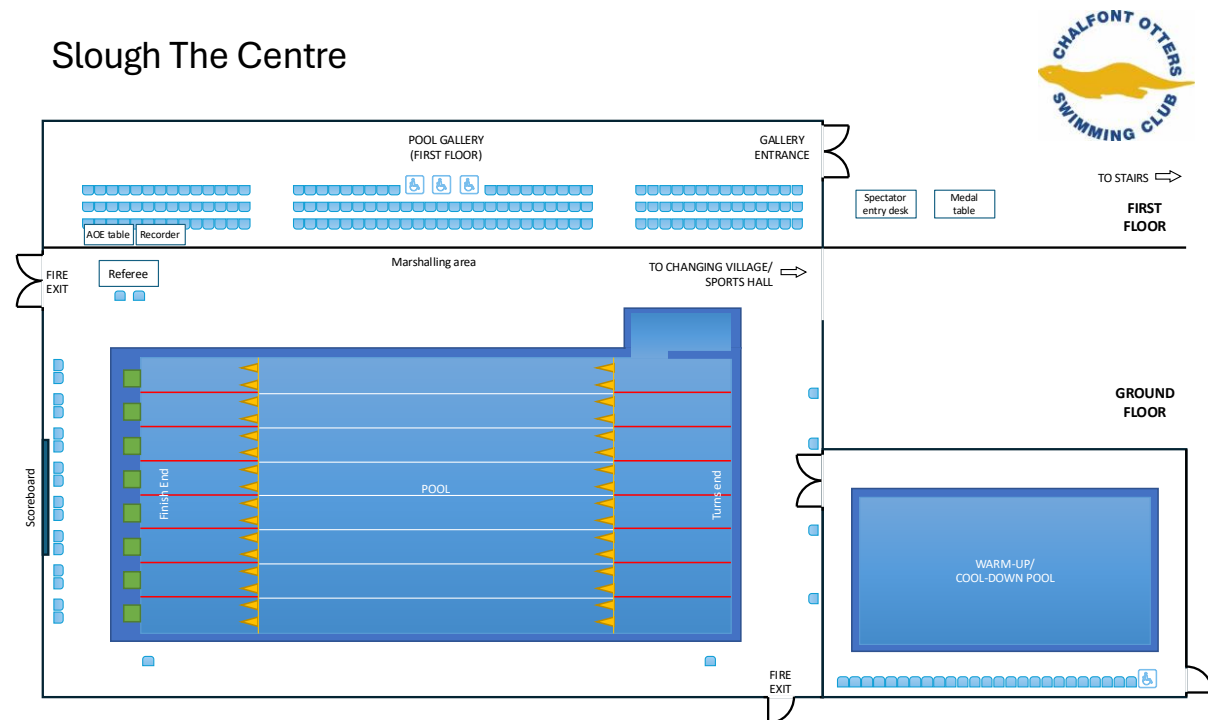

Centre layout

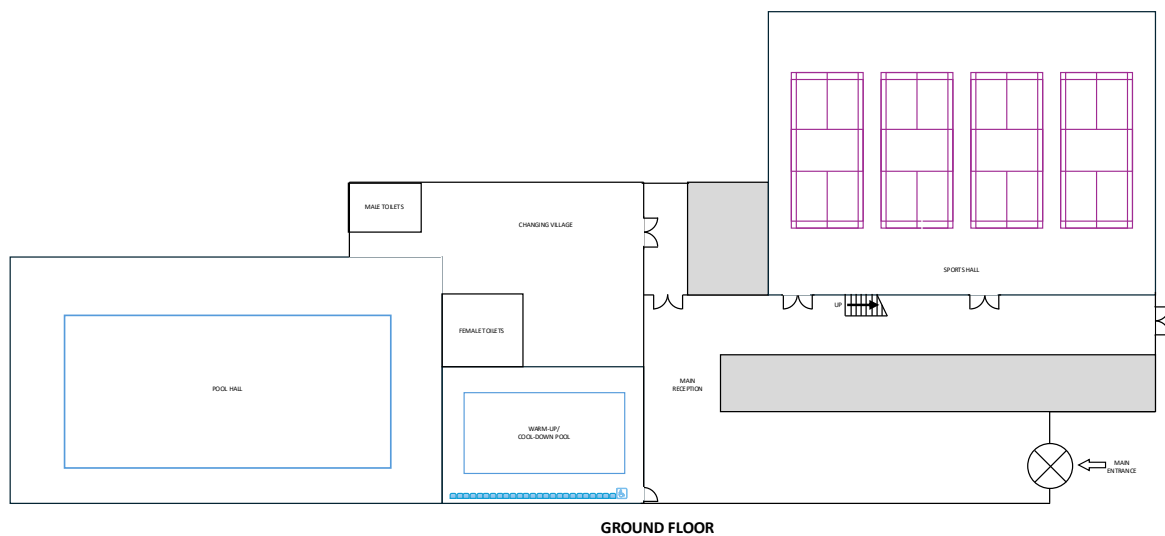

Changing village

The leisure centre has a mixed gender changing village.

Only swimmers and persons with a poolside pass are permitted to access the changing village. Under no circumstances are parents permitted to access the changing village. Contact your Team Manager or coach if you need to contact your swimmer after they enter the changing village.

Any use of a mobile phone, tablet, camera or camera-enabled device is prohibited in the changing village, regardless of whether the device is being used for purposes other than taking photographs/video. Swimmers are requested to keep phones in their bags at all times. **Any swimmer who is seen using a phone or camera in the changing village will be immediately ejected from the meet.** This includes a phone or camera being carried in the hand, irrespective of whether it is being used.

Parents please note that this means your swimmer will not be able to answer calls or texts while in the changing village.

Marshalling

Swimmers will be marshalled in the sports hall during the meet. Courts 1 and 2 will be available for club use. Designated club areas will be posted at the entrance to the sports hall.

For the safety of other centre users, swimmers are requested to ensure they are suitably dry and not to track water outside the changing village when moving between the changing village and the sports hall.

Volunteers

We welcome volunteers from visiting clubs to help us run the meet. Volunteer roles do not require any prior training and will be fully explained before the meet. Roles include swimmer marshalling, sign-in/medal table, spectator entry, and for those with technical training, AOE officiating.

If you can help, please contact openmeets@chalfontotters.org.uk with details of the session(s) you are attending and the role you are interested in.

When you arrive, please report to the welcome desk near the spectator poolside entrance, and the volunteers' coordinator will show you where you will be based and what the role requires you to do.

Officials

Officials are requested to sign up for officiating session(s) via <https://swim-meet.com/Availability/?m=8448>. Subject to having sufficient number of officials, we will be able to provide mentoring during the meet.

Poolside passes

Club packs with poolside passes will be available from the welcome desk upon arrival. All coaches/TMs must have their poolside pass visible at all times whilst poolside. Passes may be shared between coaches/TMs but the maximum number of coaches/TMs poolside must not exceed the number of poolside passes purchased. Coaches/TMs handing over to other coaches/TMs between

sessions must make their own arrangements to hand over poolside passes. Replacement passes will **not** be available and new passes will be charged at £20.

Spectator entry

Entry for spectators is £7 per session or £12 per day. Card/contactless and cash payments will be available. Entry is free for children 12 and under. Wristbands will be provided as proof of payment. Anyone without a wristband will be asked to leave the gallery.

Spectator seating is available but entry to the spectator gallery does not guarantee a seat, and you may find it necessary to stand. Our volunteers will do their best to assist you in finding a seat if you require one, and spectators are asked not to 'reserve' seats and leave them unused for part of the day. Any unattended belongings may be removed.

The spectator gallery has priority areas for wheelchair access. The walkway must be kept clear to maintain escape routes in case of emergency.

Access at the far end of the spectator gallery next to the start/finish end of the pool is restricted to authorised personnel only.

Meet results

Meet results will be published on Meet Mobile during the meet (network-permitting). Official results will be uploaded to chalfontotters.org.uk and to Swim England rankings after the meet.

Refreshments

A snack shop will be available during the meet and Farnham Road has a number of a number of cafés and shops.